

BUILT-IN COCKTAIL STATION USE AND CARE GUIDE MODELS BCS30 & BCS42



BCS42

Thank you for purchasing the Glastender Built-in Cocktail Station. We appreciate your support of American manufacturing. The Built-in Cocktail Station is a high quality, commercial-grade product that, if cared for properly, will bring you many years of enjoyment.

ASSISTANCE OR SERVICE

When calling for assistance, please have your model number, serial number, and date of purchase information available, as this information will help us to better respond to your request.

In the USA and Canada, you may contact Glastender, Inc. toll free at 800-748-0423. Office hours are Monday through Friday, 8am to 5pm EST. Please ask for the Technical Service Department.

Our complete contact information is as follows:

Glastender, Inc.
5400 North Michigan Road
Saginaw, MI 48604-9780
800-748-0423 · 989-752-4275
Fax: 989-752-4444
email: info@glastender.com
web: www.glastenderhome.com

INSTALLATION

1. Remove the Built-in Cocktail Station from the packaging. Be careful not to discard any loose parts.
2. Peel off the protective white plastic sheets wherever it is covering the stainless steel. The silver tape on the sink bowl is for sound deadening, so do not remove it.
3. Prepare the cut-out and framing supports in the cabinet where the built-in cocktail station will be installed per the diagram on the following page. Make sure to provide access doors or an access panel into the cabinet for access to plumbing.
4. Set the built-in cocktail station in place on the framing supports. Shim to level if necessary.
5. The cut-out opening will be slightly larger than the unit. Center the unit in the opening prior to securing. It may be helpful to shim the unit to prevent it from moving while you secure it to the cabinet.
6. Secure the cocktail unit to the cabinet using the angle brackets and screws provided. Use the self-drilling sheet metal screws to secure the angle bracket to the bottom of the cocktail unit. Use the wood screws to secure the angle bracket to the framing supports in the cabinet. If your framing supports are not made of wood, then you may need to get a different style screw that is appropriate for the material.
7. Remove any temporary shims that you might have used to keep the cocktail unit centered in the cut-out while securing it.
8. Apply a bead of clear silicone sealant (not included) around the perimeter of the cut-out. Use your finger to wipe away any excess silicone. Allow 24 hours for the silicone to cure before use.
9. Install the bottle rail using the screws provided.
10. Install the bottle cap catcher using the screws provided. The cap catcher is provided with keyhole slots and is designed to be removable. Leave the screws somewhat loose so the cap catcher can be easily removed and re-installed as necessary.
11. Install the bottle opener using the screws provided.
12. Mount the faucet to the cocktail unit. Reference installation instructions included with faucet.
13. Plumb the faucet and drains in accordance with local plumbing requirements. The drain fitting for the sink is provided.
14. Install the stainless condiment cup holder in the back (side opposite bottle rail) of the cocktail ice bin with the rear hinge overlapping the black thermal barrier strip around the ice bin liner. The flanges on the left and right side of the cover should rest inside the black thermal barrier strip. Insert the 3 plastic condiment cups into the rectangular cutouts of the condiment cup holder.
15. Install the ice bin cover with the handle up and toward the front of the unit. The left and right bottom edges of the cover should ride on the black thermal barrier strip around the ice bin liner.
16. The underside of the cutting board has two keyhole slots that align with the locating pins on the work surface of the cocktail unit. Set the cutting board in place and slide forward to lock into place.

17. For model BCS42, set the drainboard insert in place.

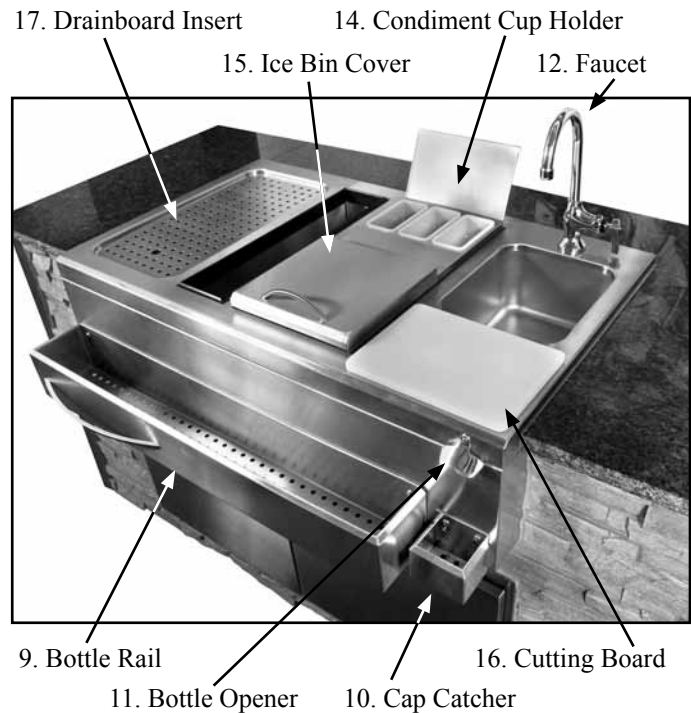

USE

Drain Screen

A drain screen has been provided in each ice bin liner to prevent debris from clogging the drain. Typically, the debris can just be picked out of the ice bin liner. The drain screen is removable for cleaning. Only remove the drain screen after all water has been drained and all debris has been removed from the ice bin. Use a small standard screwdriver to lightly pry the drain screen out of the drain. The screen is made of stainless steel, so use the same precautions when cleaning it. Rinse the screen under a faucet to remove debris and use a nylon brush if necessary.

IMPORTANT: Be careful when handling the drain screen, as the edges of the screen may be sharp.



Drain screen

Sliding Cover

The cover of the ice bin slides back and forth for access. There is no need to lift it up or off during operation.

CUT OUT AND FRAMING SUPPORT DIAGRAM

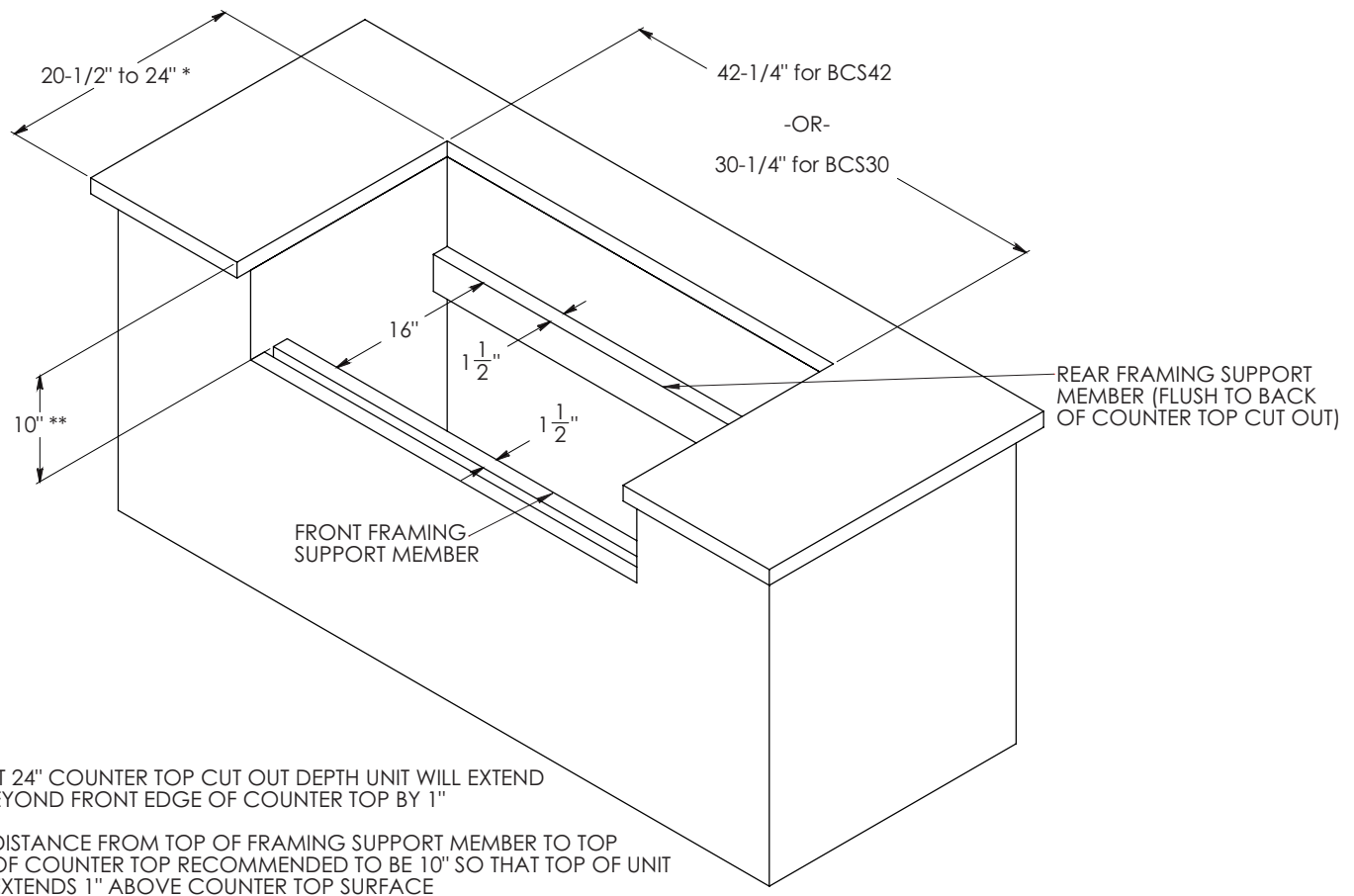

GENERAL CLEANING

IMPORTANT: Always follow label instructions on cleaning products. Soap, water and a soft cloth or sponge are suggested first unless otherwise noted.

To avoid weather damage please cover the unit when not in use or store in a covered area.

Stainless Steel Care & Cleaning:

Stainless steel will stain or rust if not cared for properly. Please pay attention to the following guidelines:

- 1. Use the proper tools** – Use non-abrasive tools, such as a soft cloth or plastic cleaning pad. NEVER use steel wool pads, soap filled scouring pads, abrasive cleaners, cleaners containing chlorine, Cooktop Polishing Creme, or gritty washcloths.
- 2. Clean with the polish lines** – Always scrub in a direction that is parallel to the grain or lines in the stainless steel.
- 3. Clean regularly** – Make cleaning easier by doing so frequently to avoid build-up of hard, stubborn stains. Use alkaline, alkaline chlorinated, or non-chloride containing cleaners.

- 4. Rinse and wipe** – Anytime chemicals are used to clean stainless steel, make sure to rinse afterward with clean water and wipe away any standing water.
- 5. Never use hydrochloric acid (muriatic acid) on stainless steel.**

Recommended cleaners for specific situations:

Stainless steel needs to be cleaned for aesthetic considerations and to preserve corrosion resistance. Stainless steel actually thrives with frequent cleaning, and, unlike some other materials, it is impossible to “wear out” stainless steel by excessive cleaning.

Routine cleaning - Use warm water, liquid detergent, ammonia, or all-purpose cleaner. Apply with soft cloth or sponge. Rinse with clean water and dry with a soft cloth.

Food spills - *Clean Immediately.* Use a stainless steel cleaner and polish. Apply with a soft cloth or sponge.

Fingerprints and smears - Use a stainless steel cleaner and polish or glass cleaner. Apply with a soft cloth or sponge.

Hard water spots - Remove with vinegar. Apply with a soft cloth or sponge.

GLASTENDER HOME PRODUCT WARRANTY

Limited Warranty

For one year from the date of purchase, when this product is operated and maintained according to the instructions attached to or furnished with the product, Glastender, Inc. will pay for Factory Specified Parts and repair labor to correct defects in materials and workmanship. Service must be authorized by the Factory in advance and must be performed by a Glastender, Inc. designated service company. This limited warranty is valid only in the United States and Canada and applies only when the product is used in the country in which it was purchased. Outside the 50 United States and Canada, this limited warranty does not apply. Proof of the original purchase date is required to obtain service under this limited warranty.

Items Excluded from Warranty

This limited warranty does not cover:

1. Service calls to correct the installation of your product, to instruct you how to use your product, or to correct house wiring or plumbing.
2. Cosmetic damage, including scratches, dents, chips or other damage to the finish of your product, unless such damage results from defects in materials or workmanship and is reported to Glastender, Inc. within 30 days from the date of purchase.
3. Repairs when your product is used for other than normal, single-family household use or when it is used in a manner that is contrary to published user or operator instructions and/or installation instructions.
4. Damage resulting from accident, alteration, misuse, abuse, fire, flood, acts of God, improper installation, installation not in accordance with electrical or plumbing codes, or use of consumables or cleaning products not approved by Glastender, Inc.
5. Cost associated with the removal from your home of your product for repairs. This product is designed to be repaired in your home and only in-home service is covered by this warranty.
6. Repairs to parts or systems resulting from unauthorized modifications made to the product.
7. Expenses for travel and transportation for product service if your product is located in a remote area where service by an authorized Glastender, Inc. service agent is not available.
8. The removal and reinstallation of your product if it is installed in an inaccessible location or is not installed in accordance with published installation instructions.
9. Damage resulting from normal wear and tear of your product.
10. Products with original model and serial numbers that have been removed, altered or cannot be easily determined. This warranty is void if the factory applied serial number has been altered or removed from your product.

The cost of repair or replacement under these excluded circumstances shall be borne by the customer.

DISCLAIMER OF IMPLIED WARRANTIES: LIMITATION OF REMEDIES

CUSTOMER'S SOLE AND EXCLUSIVE REMEDY UNDER THIS LIMITED WARRANTY SHALL BE PRODUCT REPAIR AS PROVIDED HEREIN. IMPLIED WARRANTIES, INCLUDING WARRANTIES OF MERCHANTABILITY OR FITNESS FOR A PARTICULAR PURPOSE, ARE LIMITED TO ONE YEAR OR THE SHORTEST PERIOD ALLOWED BY LAW. GLASTENDER SHALL NOT BE LIABLE FOR INCIDENTAL OR CONSEQUENTIAL DAMAGES. SOME STATES AND PROVINCES DO NOT ALLOW THE EXCLUSION OR LIMITATION OF MERCHANTABILITY OR FITNESS, SO THESE EXCLUSIONS OR LIMITATIONS MAY NOT APPLY TO YOU. THIS WARRANTY GIVES YOU SPECIAL LEGAL RIGHTS AND YOU MAY ALSO HAVE OTHER RIGHTS WHICH VARY FROM STATE TO STATE OR PROVINCE TO PROVINCE.

Please keep this document and your sales slip together for future reference. You must provide proof of purchase or installation date for in-warranty service.

Record the following information about your product to better help you obtain assistance or service if you ever need it. You will need to know your complete model number and serial number. You can find this information on the model and serial number tag located on the product.

Dealer name: _____

Address: _____

Phone Number: _____

Model Number: _____

Serial Number: _____

Purchase Date: _____